

# Tamblyn Townhomes 14-Unit Development

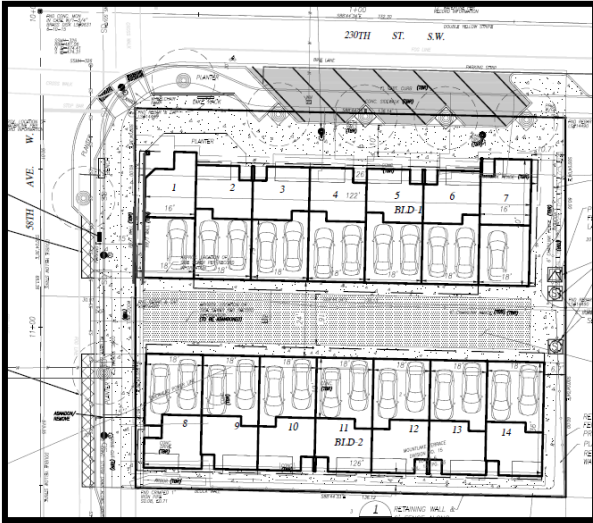

- **Location:** 5608 230<sup>th</sup> St SW and 23003 58<sup>th</sup> Ave W
- **Zoning:** Community Business Downtown (BC/D), District D
- **Applicant:** Landsverk Quality Homes, Inc. (LQH LLC)
- **Description:** Redevelopment of two residential lots, totaling 0.38 acres, into 14 fee-simple lots for three-story flex-space townhomes, contained in two buildings. Proposal has been given preliminary approval. Vehicular access to understructure garages is via a driveway off 58<sup>th</sup> Ave W. Some on-street parking is provided. Townhomes facing 230<sup>th</sup> appear to be 2-story structures due to site topography. Pedestrian activity area improvements will be added on 58<sup>th</sup>.
- **Status:** Preliminary Plat approved. Civil permit under review.