

LEGEND:

- EX PROPERTY LINE
- - - EX CITY RIGHT-OF-WAY
- //// WSDOT LIMITED ACCESS
- PERMANENT EASEMENT LINE
- x-x-x CHAINLINK FENCE (6' UNLESS OTHERWISE NOTED)
- [] PROPERTY SITE BOUNDARY
- PROPOSED LIGHT RAIL TRANSIT WAY
- - - PROPOSED RIGHT-OF-WAY
- Existing Tree Symbol
- X TREE REMOVAL

- [Hexagon Pattern] LANDSCAPE PLANTING
- [Dotted Pattern] MULCH
- [Star Symbol] OR [Cross Symbol] UTILITY POLE WITH LIGHT
- - AP - - ACOUSTIC PANEL
- [Stippled Pattern] CONCRETE SIDEWALK/
CONCRETE PAVEMENT
- [Dotted Pattern] ASPHALT

ABBREVIATIONS:

- CL CENTERLINE
- NB NORTH BOUND
- PL PLACE
- ROW RIGHT-OF-WAY
- SB SOUTH BOUND
- ST STREET
- SW SOUTHWEST
- TYP TYPICAL
- W WEST
- WSDOT WASHINGTON STATE DEPARTMENT OF TRANSPORTATION

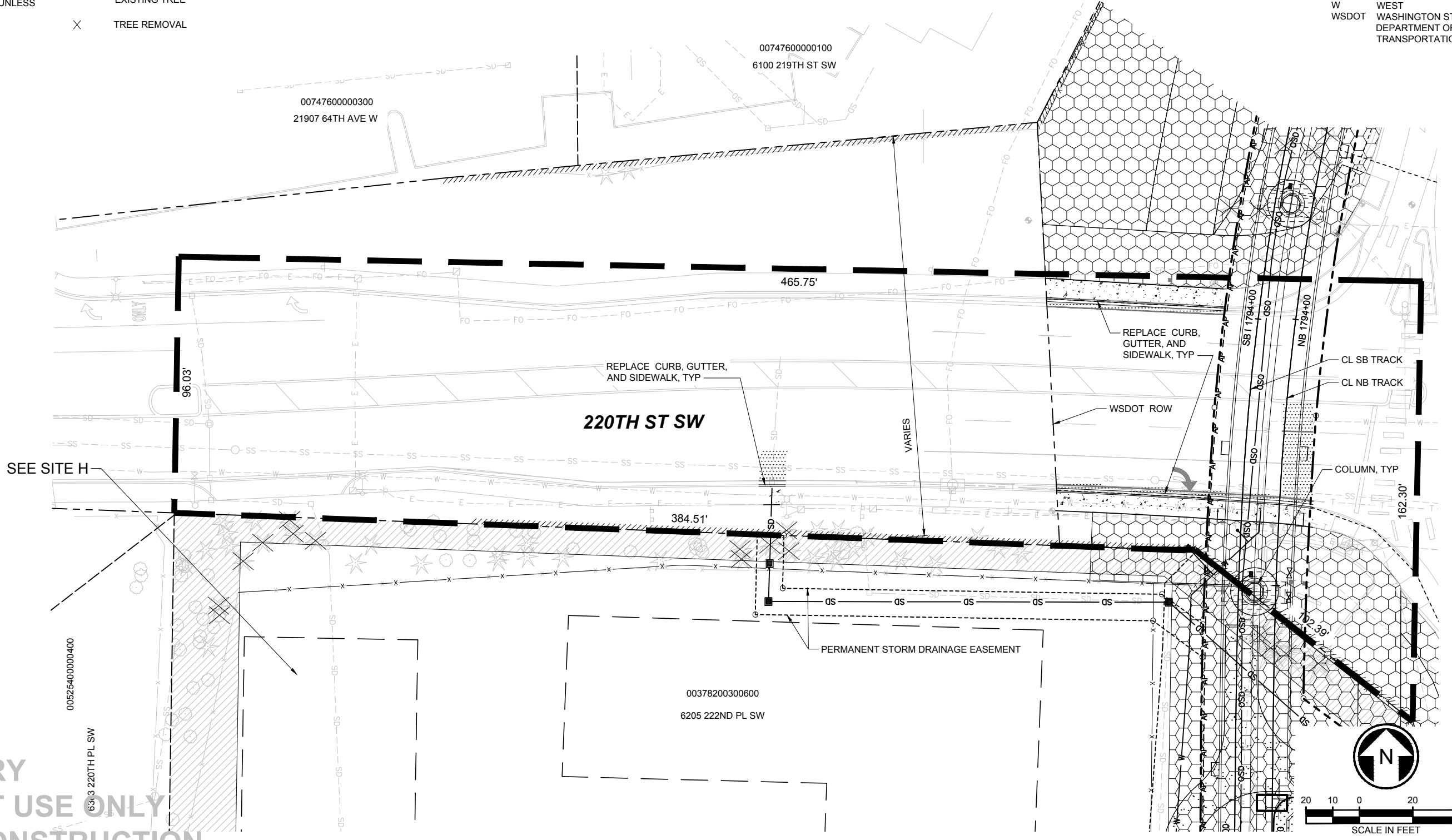

**PRELIMINARY
FOR PERMIT USE ONLY
NOT FOR CONSTRUCTION**

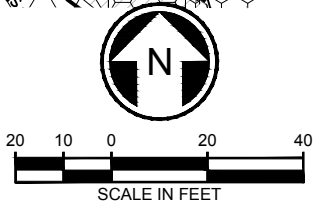

03/15/19 | 4:33 PM | LINGET
C:\CADD\BIP\W\INGET\WEST\DM\85617\MILT\CUP_NEW-SITE-PLANS.DWG

PERMIT SUBMITTAL					DESIGNED BY: VARIES		CORRECTIONS				SCALE:		LYNNWOOD LINK EXTENSION CONTRACT L300 NE 200TH STREET TO LYNNWOOD TRANSIT CENTER SITE I SITE PLAN WITHIN THE 220TH STREET SW RIGHT-OF-WAY		DRAWING No.: 1	
1 3/15/19 JBL BE JWJ					DRAWN BY: LINGET						FILENAME:				CONTRACT No.:	
No. DATE DSN CHK APP REVISION					CHECKED BY: S. KITTERMAN		SUBMITTED BY: K. COLLINS		DATE:		DATE:		11/29/2018		SHEET No.: REV:	
					APPROVED BY: J. SCHETTER		REVIEWED BY: F. CHIHAB		DATE:							