

LEGEND:

- EX PROPERTY LINE
- EX CITY RIGHT-OF-WAY
- ////// WSDOT LIMITED ACCESS
- PERMANENT EASEMENT LINE
- CHAINLINK FENCE (6' UNLESS OTHERWISE NOTED)
- [] PROPERTY SITE BOUNDARY
- PROPOSED LIGHT RAIL TRANSIT WAY
- PROPOSED RIGHT-OF-WAY
- EXISTING TREE
- X TREE REMOVAL

- DECIDUOUS TREES
- LANDSCAPE PLANTING
- MULCH

- CONCRETE SIDEWALK/ CONCRETE PAVEMENT
- ASPHALT

- NOISE WALLS
- RETAINING WALL ALIGNMENT
- CURB
- ACOUSTIC PANEL
- UTILITY POLE WITH LIGHT

ABBREVIATIONS:

- AVE AVENUE
- CL CENTERLINE
- EX EXISTING
- PL PLACE
- ROW RIGHT-OF-WAY
- SB SOUTH BOUND
- ST STREET
- SW SOUTHWEST
- TYP TYPICAL
- W WEST
- WSDOT WASHINGTON STATE DEPARTMENT OF TRANSPORTATION

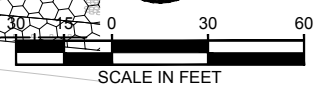
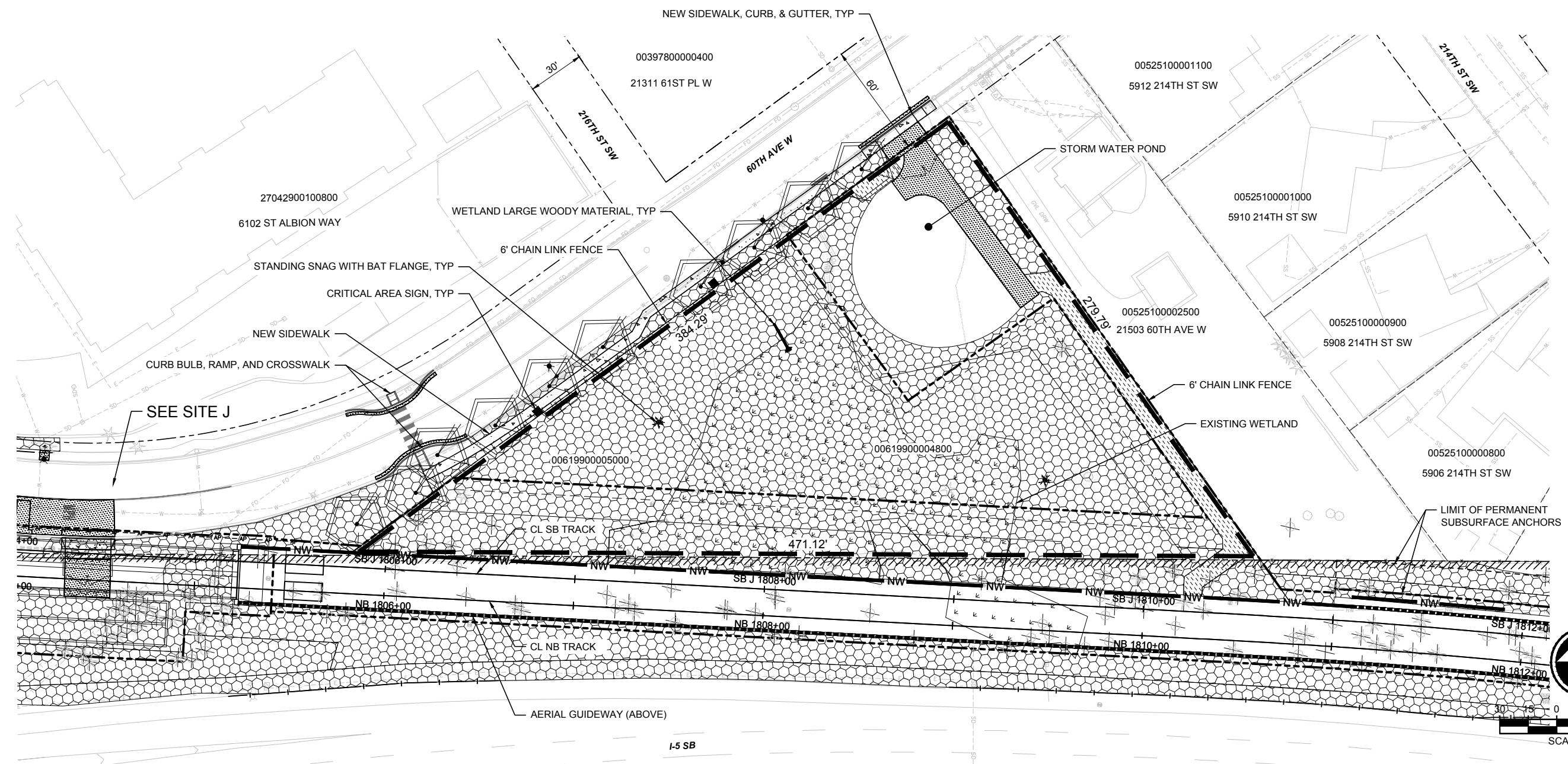

11/20/18 | 3:28 PM | MNICMPREATH | C:\CADD\BIP\MNICMPREATH\WEST\IDMS95817\M1 T-CUP_SITE-PLANS_2.5.DWG

PERMIT SUBMITTAL

DESIGNED BY:
VARIES
DRAWN BY:
L. NGET
CHECKED BY:
S. KITTERMAN
APPROVED BY:
J. SCHELLER

**PRELIMINARY
NOT FOR CONSTRUCTION**



SCALE:
FILENAME:
CONTRACT No.:
RTA / CN 0010-16
DATE:
11/29/2018

**LYNNWOOD LINK EXTENSION
CONTRACT L300**
NE 200TH STREET TO LYNNWOOD TRANSIT CENTER
**SITE K
SITE PLAN**
ADJACENT (SOUTH) OF 21503 60TH AVENUE W

DRAWING No.:
K
LOCATION ID:
SHEET No.: REV:

No.	DATE	DSN	CHK	APP	REVISION

SUBMITTED BY: K. COLLINS
DATE: 11/29/2018
REVIEWED BY: F. CHIHAB
DATE: 11/29/2018